

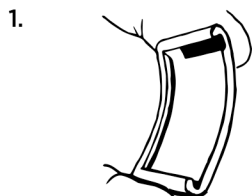

Hello fellow baker! Thank you for purchasing an Arc lame. I know you're excited to get started, but please take a moment to slowly work through the steps below and learn how to install the blade safely into your Arc lame. It may seem complicated, but once you've done it a few times, it will quickly become second nature. I will remind you that razor blades are unforgivingly sharp and you must be very cautious when handling them. If you would like to see a video of the blade installation, please go to wiremonkey.com FAQ section. (The QR code will take you there.)

SCAN ME!

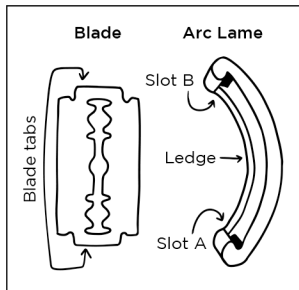

1. With one hand, hold the end of the arc between the thumb and index finger.



2. With the other hand, firmly hold the middle of the blade while carefully positioning one end of the blade all the way into slot A.

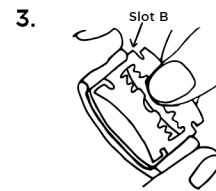

3. Carefully bend the blade in an upward arc and place the other blade tab into slot B.



4. Using your thumb, push down on the center the blade and it will snap into place. The edge of the blade should be resting against the ledge of the arc lame. You are ready to score!

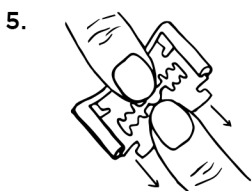

5. To remove the blade, grasp the arc ledge with one hand and the blade with the other. Give a quick tug and the blade will slide out.

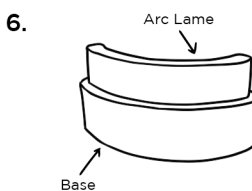

6. You can store the arc lame, with the blade installed, on the base.

Keep wooden lames well oiled, this will prevent warping and keep them from drying out. Use an oil that will not go rancid. We highly recommend Wire Monkey brand fractionated coconut oil. Say no to mineral oil, which is derived from petroleum.

CAUTION!
RAZOR BLADES ARE VERY SHARP AND CAN INJURE YOU! Always keep fingers and body away from the sharp edge of the blade. Keep out of children's reach. Dispose of blades properly. Wire Monkey will not be held responsible for injury.



Hello fellow baker! Thank you for purchasing an Arc lame. I know you're excited to get started, but please take a moment to slowly work through the steps below and learn how to install the blade safely into your Arc lame. It may seem complicated, but once you've done it a few times, it will quickly become second nature. I will remind you that razor blades are unforgivingly sharp and you must be very cautious when handling them. If you would like to see a video of the blade installation, please go to wiremonkey.com FAQ section. (The QR code will take you there.)

SCAN ME!

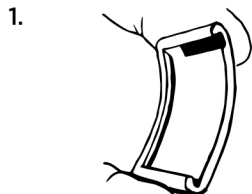
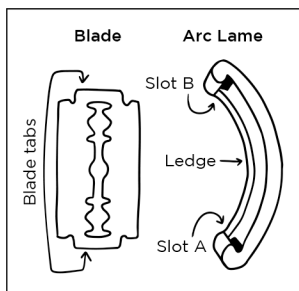

1. With one hand, hold the end of the arc between the thumb and index finger.



2. With the other hand, firmly hold the middle of the blade while carefully positioning one end of the blade all the way into slot A.

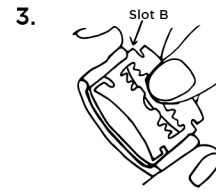

3. Carefully bend the blade in an upward arc and place the other blade tab into slot B.



4. Using your thumb, push down on the center the blade and it will snap into place. The edge of the blade should be resting against the ledge of the arc lame. You are ready to score!

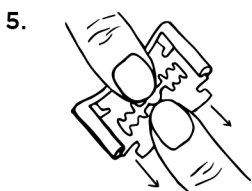

5. To remove the blade, grasp the arc ledge with one hand and the blade with the other. Give a quick tug and the blade will slide out.

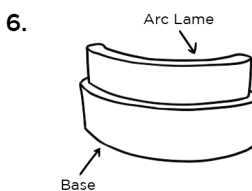

6. You can store the arc lame, with the blade installed, on the base.

Keep wooden lames well oiled, this will prevent warping and keep them from drying out. Use an oil that will not go rancid. We highly recommend Wire Monkey brand fractionated coconut oil. Say no to mineral oil, which is derived from petroleum.

CAUTION!
RAZOR BLADES ARE VERY SHARP AND CAN INJURE YOU! Always keep fingers and body away from the sharp edge of the blade. Keep out of children's reach. Dispose of blades properly. Wire Monkey will not be held responsible for injury.